

ROLLER SHADE WITH PVC VALANCE INSTALLATION INSTRUCTIONS

INSIDE/WALL TO WALL CEILING MOUNT SECTION

1. Install Roller Shade Brackets first as per attached instruction sheet for “Fitting the Brackets”

DO NOT INSTALL ROLLER SHADE YET.

2. PVC Valance has been notched on both ends on the roof of valance so as not to interfere with installed brackets. See Fig. 1.
3. Install clear corners on ends of valance only if required before you install Valance.
4. Put Valance in place and screw through the roof of the valance to the inside of frame/ceiling. Use appropriate amount of screws to hold valance in place. Pre-drilling holes on roof of valance will help. You must ensure that the inside front of valance does not interfere with brackets and or roller mechanism. Leave a distance of approximately ½” to 1” from end of roller bracket.
5. You are now ready to install Roller Shade. See section for “Fitting the Blind” on attached installation sheet.
6. Ensure Child Safety Chain/Cord Hold Down Device is installed as per instruction sheet.

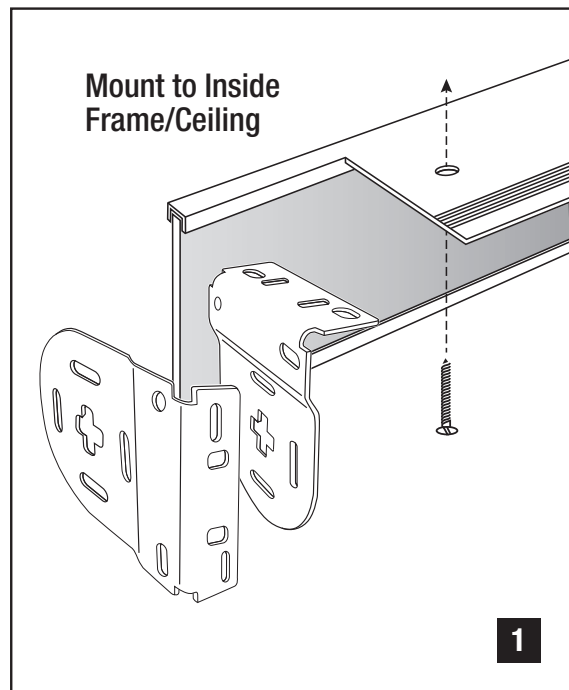

PLEASE NOTE: Screws provided are for installing into wood only.

OUTSIDE/WALL MOUNT

1. Install Roller Shade Brackets as per attached instruction sheet for “Fitting the Brackets”.

DO NOT INSTALL ROLLER SHADE YET.

2. Install Valance brackets as per Fig. 2. Brackets should be installed approximately 4” from each end and spaced out evenly according to size of valance. Ensure valance brackets are mounted above installed roller brackets so as not to interfere when installing shade. Valance brackets should be installed approximately ½” to 1” above roller brackets. See Fig. 2.
3. Install Roller Shade.
4. Assemble Valance before installing on installed shade. See Valance assembly on reverse side.

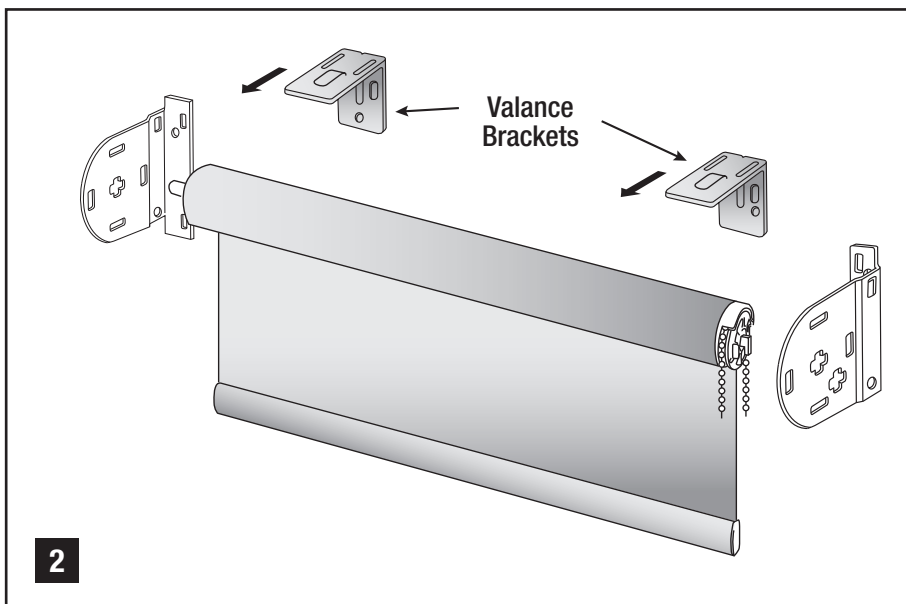

Proudly Canadian
Owned & Operated

ROLLER SHADE WITH PVC VALANCE INSTALLATION INSTRUCTIONS

5. Center the valance over the installed roller Shade.
Place the roof of completely assembled valance into the metal notched part on the top of valance bracket. Push roof of valance into the pressure fit notch of bracket. Roof of valance should be secured properly into the pressure fit notch lip.

Valance returns should be resting and against wall.
See Fig. 3.

VALANCE ASSEMBLY

The valance is to be mounted after the total installation.

- 1 Attach the corner pieces into the back slot of the main valance section. Insert the side returns of the valance into the corner pieces. See Fig. A

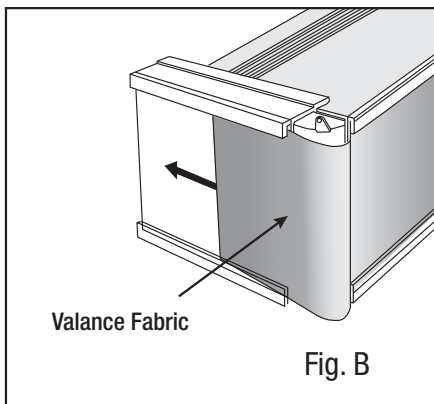

- 2 Slide the excess fabric from the end of main valance into the side return grooves. See Fig. B

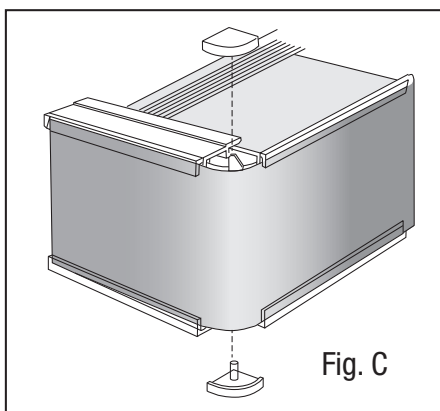

- 3 Insert the plastic top and bottom and push to secure the entire valance. See Fig. C

PLEASE NOTE: Screws provided are for installing into wood only.

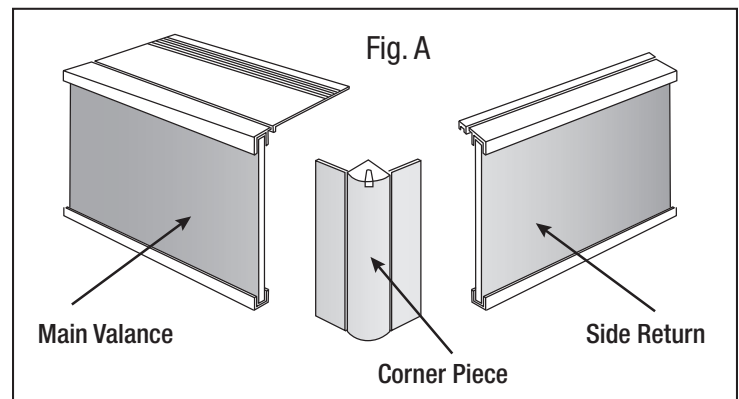
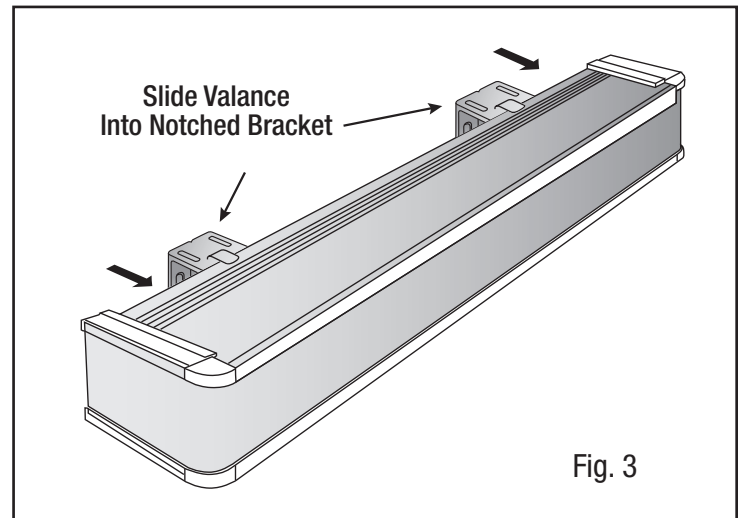

⚠ WARNING

 The cords on this product present a potential strangulation hazard.

 For child safety, consider cordless alternatives or products with inaccessible cords.

⚠ MISE EN GARDE

 Les cordons de ce produit présentent un risque d'étranglement.

 Pour la sécurité des enfants, envisagez à choisir des produits sans cordon ou des produits dont les cordons ne sont pas accessibles.

5.1.3. & 5.1.4